

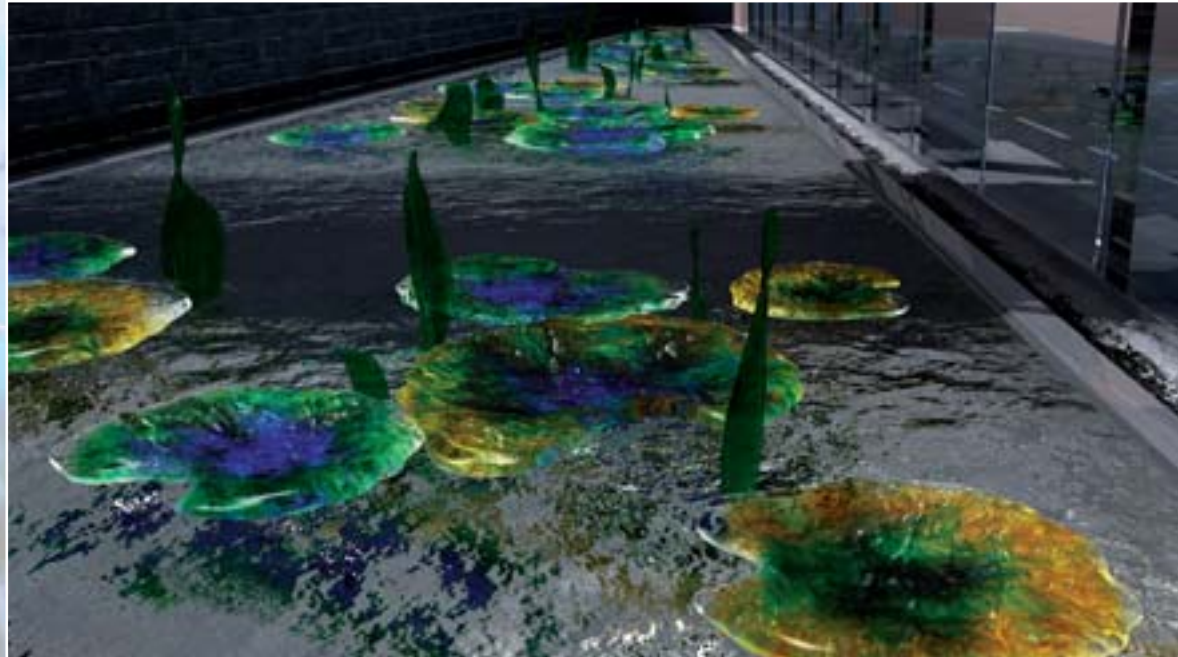

PRECIOSA



LIGHTING PROJECTS

Bulletin No. IX

YEAR 2008



DEAR FRIENDS,

You have just opened our Bulletin No. IX, containing information about our latest lighting projects that are currently in the works or have recently been carried out.

On pages 2 - 3, you will find information about a documentary film shot for the German TV PRO7's GALILEO program.

On pages 4 - 6, you can become acquainted with current trends in chandelier design.

On page 7, we are happy to share with you the inspiration we gained at the Maison et Objet Exhibition in Paris, January 2008.

The Miscellanea section, pages 32 - 33, shows our endeavors to improve the quality of surface finishes applied to metal parts of our lighting fixtures.

CONTENTS

■ The Company's Activities	2 - 3
■ Inspiration	4 - 7
■ Completed and Open Projects	8 - 23
■ New Creative Ideas	24 - 31
■ Miscellanea	32 - 33
■ Update on Selected References	34 - 35
■ Contacts	36

You are cordially invited to visit our stand at the FIAM 2008 Exhibition held in Valencia, Spain, from 23 to 27 September 2008.

THE GERMAN TV PRO7 SHOOTING A DOCUMENTARY FILM AT PRECIOSA - LUSTRY

The German TV PRO7 asked our company to cooperate in shooting a documentary film for the TV's Galileo Magazine, which is one of the most popular TV programs in Germany, Austria and Switzerland, broadcast daily from 19 to 20.15 hours.

Galileo tries, above all, to link everyday science and technology experiences and covers various topics from science to medicine, from lifestyle to technology in a customer-friendly and accessible way; most of the films, each lasting from 4 to 18 minutes, feature the main question: "How do they do it?"

The aim of the magazine is to entertain people through scientainment, thus popularizing new pieces of scientific knowledge about the world we live in.

The documentary film, shot at our company, deals with the manufacture of a unique lighting fixture at Preciosa - Lustry in November 2007. This fountain-shaped glass chandelier, 179 cm in width and 575 cm in height, forms part of a large lighting project designed for a private customer in U.A.E.



The Galileo magazine's film crew making preparations to shoot in our company's plants.



The TV crew shooting directly in our foundry where metal parts for the glass "fountain" were being cast.

The above-mentioned documentary, telecast as part of the upcoming January Galileo Magazine on TV PRO7, will present the manufacture of the "fountain" chandelier, tracing it from the very beginning, i.e. from design, excavation of glassmaking sand to the meticulous manufacture of individual chandelier parts and finally the trial assembly of this unique lighting object, all this taking place in front of the TV cameras in Preciosa - Lustry's assembly hall.

The film crew, headed by Ms. Monika Latzel, consisted of Mr. Axel Grabmann, director of photography, and his assistant.

THE GERMAN TV PRO7 SHOOTING A DOCUMENTARY FILM AT PRECIOSA - LUSTRY



The packing of the fountain's glass leaf-shaped parts.



The trial assembly of the fountain was filmed from the very beginning.

The result of the trial assembly served as a business presentation to be assessed by the customer.

The shots of the fountain's testing installation are displayed on the closing frames of one of Galileo TV Magazines.



A close-up of the chandelier.



LIGHTING PROJECTS – TRENDS IN THE STYLES OF LIGHTING SYSTEMS DESIGNED FOR SPECIAL INTERIORS

We have prepared, in cooperation with Mr. Bejvl Jr, the company's chief designer, the following outline of the most frequent trends in lighting fixture design intended for special interiors, such as hotel lounges, restaurants and other interiors for social events.

1. Geometrical shapes formed from crystal components (TRENDS)

The prevailing trend in lighting styles is characterized by geometrically pure shapes of lighting fixtures decorated with classical types of chandelier trimmings.

These fixtures have simple geometrical shapes, such as cylinders, cubes, rectangles and other shapes, and are decorated with classical trimmings, such as, for instance, beads, octagons and prisms.

The design of these geometrically shaped lighting fixtures is based on minimal usage of metal and other constructional elements used so that the final product may give the impression of a monolithic glass object, with crystal being most frequently used for this purpose. Such lighting fixtures are usually installed in special interiors as solitary, dominant objects.

Hotel St.Regis, Singapore, 046 026 013 - 00
diam 100cm/ 39,3 in



Harlan's Restaurant, Hong Kong.
043 906 001 - 05
25 x 109 cm/ 10 x 43 in



68 5001 003 90 01 02 35
61 x 58 x 31 cm/24 x 23 x 12 in

LIGHTING PROJECTS – TRENDS IN THE STYLES OF LIGHTING SYSTEMS DESIGNED FOR SPECIAL INTERIORS

2. The colored classic (TRENDS)

Classical shapes of crystal lighting fixtures are colored to create strong shades. The fixtures' classical form can be accentuated by distinctive elements of modern morphology.

Modern interiors with classical elements are a fashion statement in current interior design. Classical lighting fixtures now feature strong color accents, which is an essential prerequisite for installation in modern, trendy interiors. Thus, rich classical forms of historically inspired chandeliers provide a striking contrast to many a fashionably austere interior.



The Mulia Hotel – the Mulia Café, Jakarta
045 132 021 - 20
100x140 cm/39x 55 in



CJ's Bar – the Mulia Hotel, Jakarta
040 799 016 - 02
100x100+Lcm/39x39+L in

NEW 2008 / LIGHT + BUILDING 2008



Chudenice
AC 5459/00/012 - Crystal
90x67 cm/ 35x26 in



Chudenice
AC 5459/00/012 - Black
90x67 cm/ 35x26 in



Santini
AM 5266/00/008 - Black
70x88 cm/28x35 in

LIGHTING PROJECTS – TRENDS IN THE STYLES OF LIGHTING SYSTEMS DESIGNED FOR SPECIAL INTERIORS

3. Loose crystal curtain walls (TRENDS)

There is a growing trend in interior design characterized by configurations of loosely suspended glass components forming distinctive, massive walls that are used as conceptual elements interlinking individual sections of interiors.

These dangling glass components arranged in various configurations can also form large shapes enabling designers to create not only various visual compositions – patterns as dominant features of the interior, but also unobtrusive visual elements giving the interior a homey touch.



Hotel St.Regis, Singapore
046 119 006 - 02
618 x 15 x 270 cm/ 244 x 6 x 106 in



Hotel InterContinental, Dubai
045 623 020 - 05,06
260 x 200 cm/102 x 91 in



Red Rock Casino, Las Vegas
044 579 028 - 11
930 x 350,5 x 20 cm/ 366 x 138 x 8 in

PRECIOSA – LUSTRY AT THE MAISON ET OBJECT 2008

FAIR IN PARIS

In January 2008, our company took part in the Maison et Objet International Design, Home Furnishings and Accessories Fair. As the fair is usually visited not only by potential buyers for residential lighting fixtures but also by architects and designers, Preciosa – Lustry exhibited a standard collection of three types of lighting fixtures in trendy, elegant colors – carmine, black and crystal to provide architects and designers with inspiration for innovative color schemes.

As we are aware that not only attractive exhibits themselves but also the look of the display stand make the exhibition inspiring and successful, the company's chief designer Mr. Jaroslav Bejvl Jr created a stylish stand design, tailoring it to the character of the selected exhibits.



Smichov, AC 5570/01/012
100 x 130 cm/ 39 x 51 in



Odetta, AS 5371/00/008
78 x 68 cm/ 31 x 27 in



Vinohrady, AC 5570/00/012
84 x 94 cm/ 33 x 37 in



Egmont, AS 5519/00/005
62 x 76 cm/ 24 x 30 in



Desdemona, AS 5519/00/008
62 x 76 cm/ 24 x 30 in



Karlin, AC 5570/00/006
61 x 62 cm/ 24 x 24 in



Otello, AS 5519/00/012
89 x 103 cm/ 35 x 41 in



Odile, AS 5371/00/008
78 x 68 cm/ 31 x 27 in



Eroica, AS 5271/ 01/006
63 x 57 cm/ 25 x 22 in

Mr. Jaroslav Bejvl Jr's design of the exhibition



THE CZARICYNNO PALACE, MOSCOW, RUSSIA

Large-scale restoration work on this famous Russian czars' residence began in 2005 after the Russian government decided in favor of extensive renovations to the buildings. The original palace complex was built at the instigation of Catherine the Great, Empress of Russia, in 1776 – 1785. Built in Classicism and Gothic styles, the palace, surrounded by an ample park and a number of adjoining buildings, was to become a real architectural gem of Czarist Russia. However, on Catherine's death, the building works were halted and the entire complex waited for resurrection until 2005.

Preciosa - Lustry entered into the restoration project in cooperation with the Mosproject 2 Studio in August 2006. Our task was to design and manufacture period chandeliers.



The course of the restoration



An old picture – the Czaricynno Palace before the restoration

The Czaricynno Palace after the restoration



THE CZARICYNO PALACE, MOSCOW, RUSSIA

The Palace's Small Hall

Lighting fixtures for the Palace's Small Hall were designed after the period chandelier from 1793 that was made for Saint Petersburg's Winter Palace. The collection of fixtures for the hall's center was rounded off with lanterns based on fixture types similar to those from the same period.

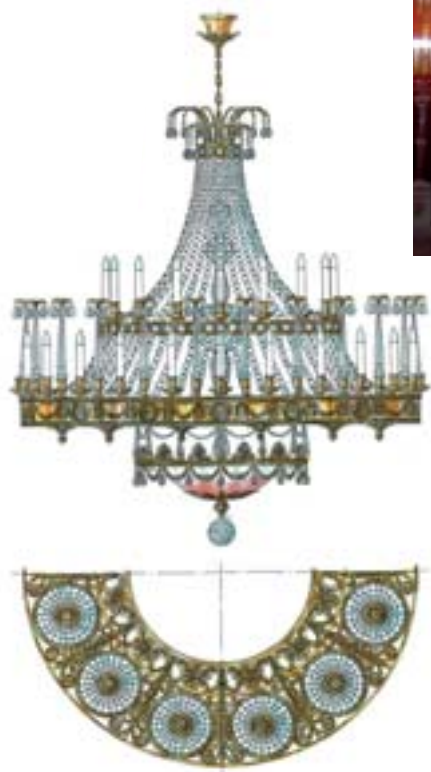

010 610 086 - 01
200 x 195 cm/ 79 x 77 in

The chandelier's shape is based on two circles joined together. The upper circle is set with machine-cut crystal stones while the lower one is decorated with bronze portraits, masks and garlands in high relief. Beneath them, in the fixture's centre, there is a bowl made of ruby glass. The overall "antique" look of the chandelier is enhanced by glass obelisks with little metal crowns and cut crystals suspended from them. The chandelier's bottom part is formed from richly decorated bronze castings set with cut crystal and arranged into various patterns



THE CZARICYN PALACE, MOSCOW, RUSSIA

The Palace's Great Hall

The Great Hall is illuminated by chandeliers of the Versailles variety. The origin of these, dating back to the latter half of the seventeenth century, is linked with King Louis XIV and his decision to transform his father's castle in Versailles into the court's and government's seat. At that time and for that castle, a new type of chandelier was designed and since then it has been called after the castle's name – the "Versailles" chandelier. This is an all-metal chandelier with glass components (center parts, bobeches) and cut chandelier trimmings. The fixture's metal frame is formed from both brass and bronze sections embellished with decorative castings.



A preliminary project sketch

THE CZARICYN PALACE, MOSCOW, RUSSIA



010 616 185 - 28
250 x 300 cm/ 98 x 118 in

The Palace's Great Hall

Three chandeliers, designed for the Great Hall's main section, have a brass frame gold plated with a layer of 1 μ thickness. The frame with decorative brass castings is set with machine-cut crystal parts and trimmings of the pendeloque type. The shapes of chandelier trimmings were carefully selected using the best available historical sources as a guide. The bottom part is decorated with large-sized, up to a maximum of 30 cm, lilac blue-colored chandelier trimmings. In the chandelier's upper part are placed halogen bulbs that illuminate a richly shaped and gilded coffered ceiling. In addition, the hall is furnished with a number of smaller chandeliers and wall brackets designed in the same style.



THE MANDARIN ORIENTAL HOTEL, PRAGUE, CZECH REPUBLIC

The Mandarin Oriental hotel in Prague is a carefully restored monastery with roots dating back to the fourteenth century. Surrounded by the quiet cobbled streets of the Lesser Town, just beneath Prague Castle, our guests can immerse themselves in the historic ambience for which Prague city is renowned. Since opened to the public a year ago, the hotel has won a number of international awards.



The hotel building



The hotel lobby
045 776 009 - 00
55 x 83 + L cm/ 22 x 33 + L in

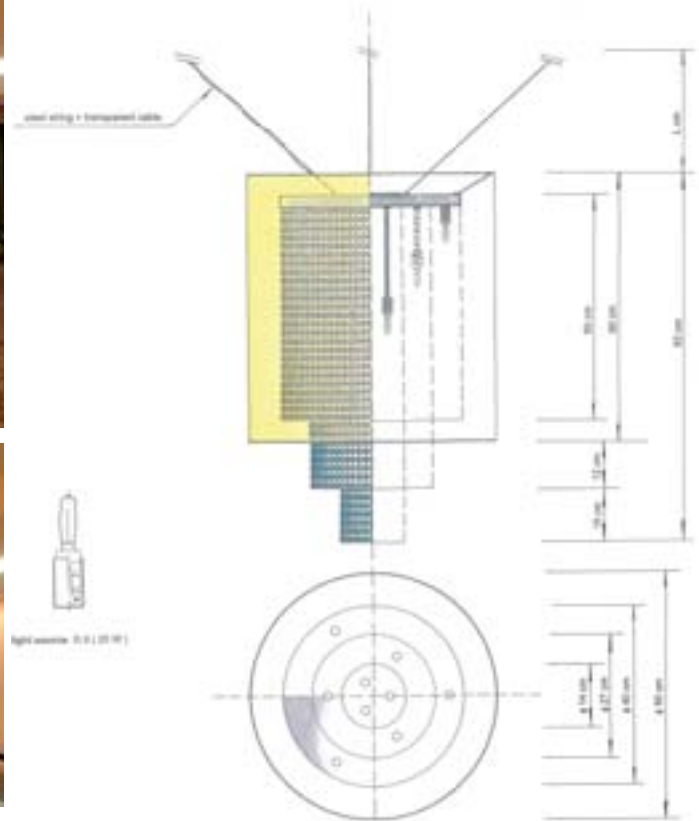

***THE MANDARIN ORIENTAL HOTEL, PRAGUE,
CZECH REPUBLIC***



045 092 048 - 00
120 x 180 cm/ 47 x 71 in

For the hotel's Grand Ballroom, Preciosa - Lustry designed and manufactured five basket lighting fixtures in a classical style.

The Grand Ballroom is a hall of 172 square meters with a capacity of 120 people. Beautiful ceilings with brilliant crystal chandeliers dominate this magnificent room, just cut out for weddings, reunions and private parties.



THE CONRAD HOTEL, INDIANAPOLIS, U.S.A.



The hotel building

The Hotel Lobby

For the hotel lobby, eight wall brackets were manufactured using mouth-blown and drawn glass in amber.



A wall bracket
042 956 002 - 02
 25 x 76 x 12 cm / 10 x 30 x 5 in



043 742 076 - 02
 213 x 183 cm / 84 x 72 in

The chandelier designed for the hotel lobby is assembled from mouth-blown beams of crystal and amber glass with golden scales fused into the beams. Among the beams are placed halogen bulbs.



The meeting room

The fixture designed for the meeting room is formed from spectrum glass components fixed in matte brass frame.

044 003 008 - 02
 91 x 76 cm / 36 x 30 in

THE CONRAD HOTEL, INDIANAPOLIS, U.S.A.

The Vitesse Bar

Lighting fixtures for the Vitesse bar have shades of opal glass, with arms created from fused spectrum glass in earthy shades.



043 789 016 - 02
122 x 76 + L cm / 48 x 30 + L in



043 998 001 - 00
18 x 76 + L 71 cm / 7 x 30 + L 30 in

Completed and Open Projects



The Grand Staircase



044 004 011 - 00
71 x 198 cm/ 30 x 80 in



A preliminary project sketch



THE CONRAD HOTEL, INDIANAPOLIS, U.S.A.

The Vienna Ballroom



044 002 040 - 01
213 x 90 + L cm/ 84 x 35 + L in

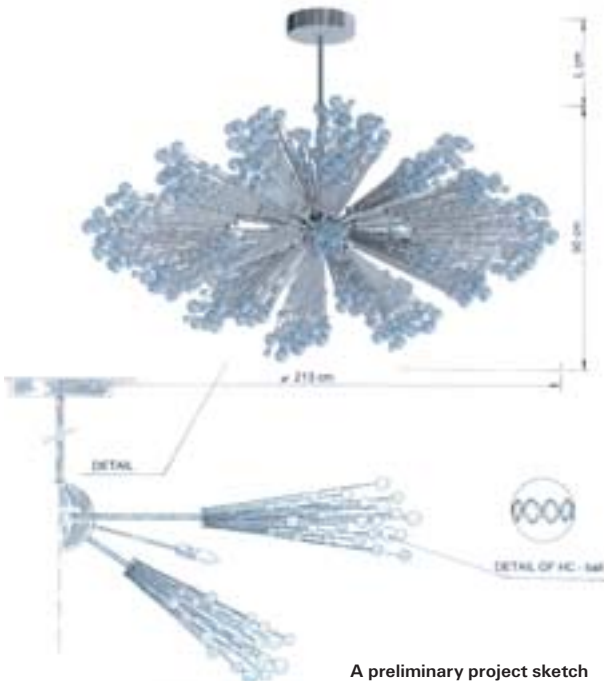

A preliminary project sketch



A close-up of the fixture



THE SUZHOU SCIENCE, TECHNOLOGY, CULTURE & ART CENTER, SUZHOU, CHINA



A view of the building

The Suzhou Science, Technology, Culture & Art Center, the largest cultural and art complex in Suzhou, was opened in October 2007. A news release issued at the Center on May 29 announced the latest progress of both construction and engineering works and the scheduled art shows after the Center was opened. Xu Guoqiang, Executive Member and Director of the Propaganda Department of CPC Suzhou Municipal Committee, attended the news release.

The foundations of the Center were laid in May 2005, and the construction itself was completed within two years. Now, the Center has entered the stage of final decoration and furnishing and testing. The total floorage of the Center is 150,000 m².

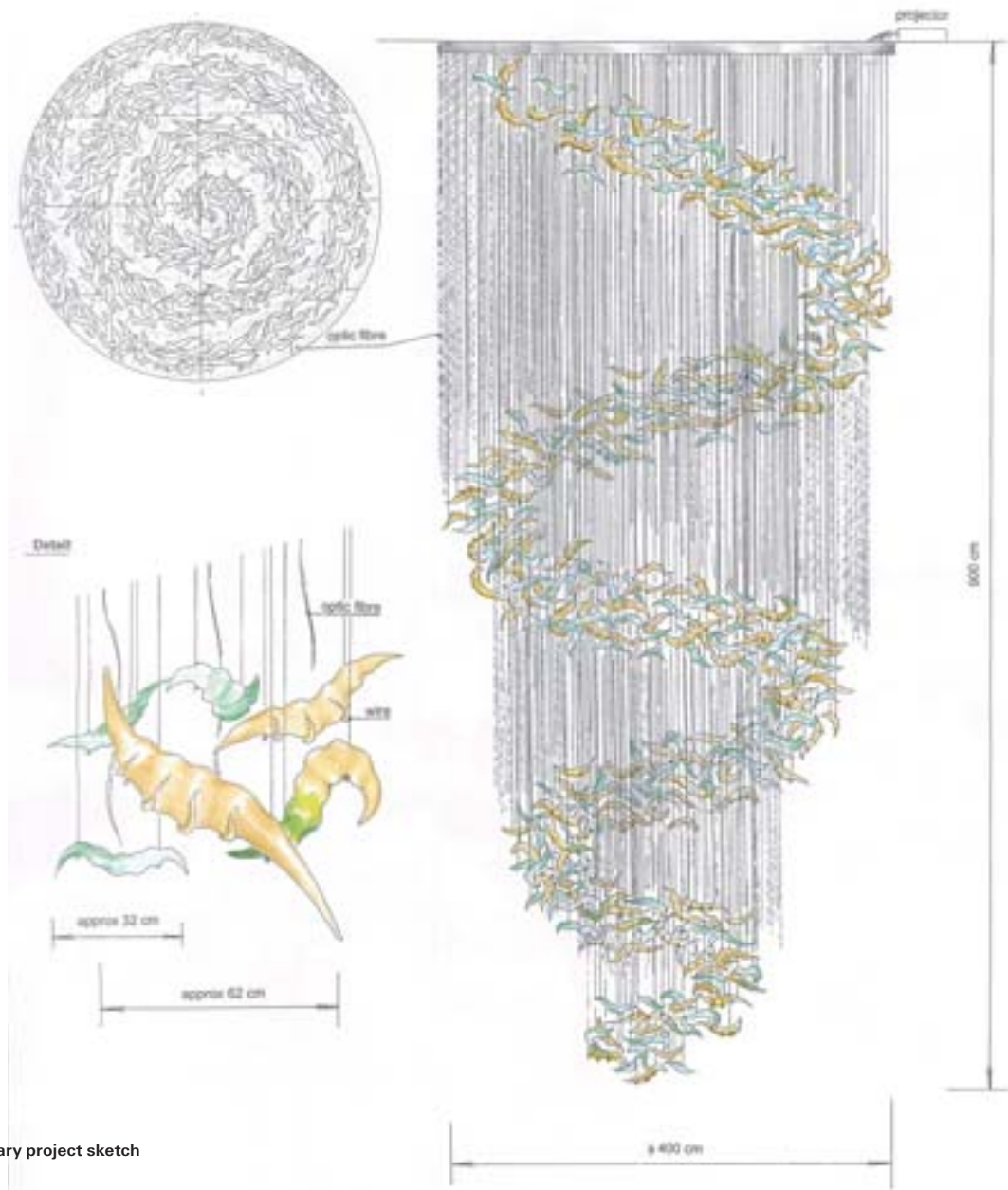

A preliminary project sketch

**THE SUZHOU SCIENCE, TECHNOLOGY, CULTURE
& ART CENTER, SUZHOU, CHINA**

The Dining Foyer
044 967 021 - 07
400 x 900 cm/ 157 x 354 in



A close-up



The direct inspiration for the fixture's horn-shaped glass parts

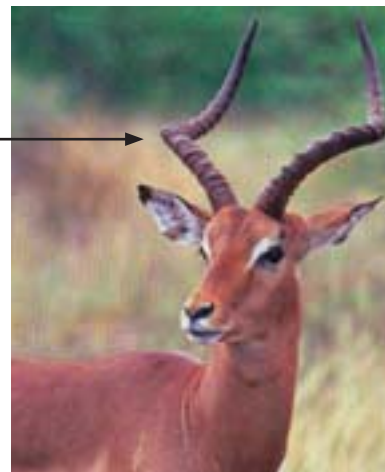

The architect's task to create this original sculpture was specified by the requirement to shape the sculpture's glass components into the horns of a mythic antelope appearing in many fables that originated in this part of China. Hand-shaped glass components, each of which is an original, were colored in delicate shades of amber, gold ruby and green, using a special glazing technique. The spiral shapes are decorated with glass threads and the entire sculpture is illuminated by halogen bulbs placed inside the fixture's frame.



THE MULIA HOTEL & MULIA CAFÉ, SENAYAN, JAKARTA, INDONESIA



The hotel building



A close-up of the fixture

Leaves hand shaped from amber glass are fixed to the fixture's metal frame. All glass parts are decorated with mica particles that resemble golden scales.



**THE MULIA HOTEL & MULIA CAFÉ, SENAYAN, JAKARTA,
INDONESIA**

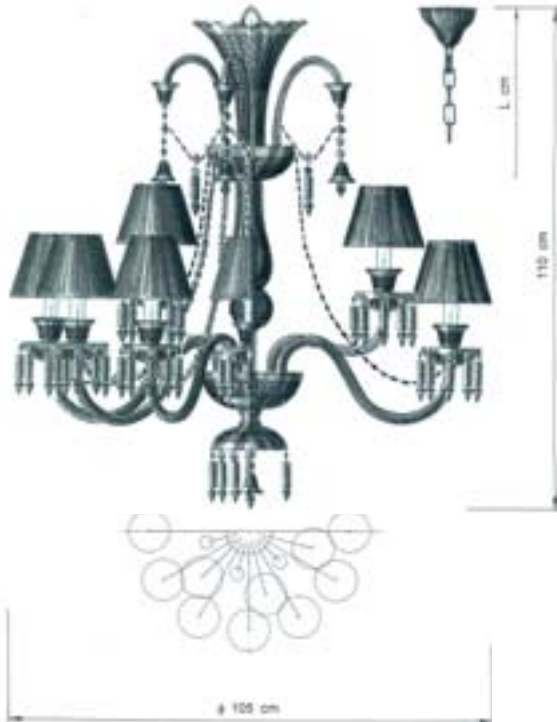

A preliminary sketch



045 132 021 - 20
100 x 140 cm / 39 x 55 in



046 707 240 - 00
250 x 50 x 150 cm / 98 x 20 x 59 in

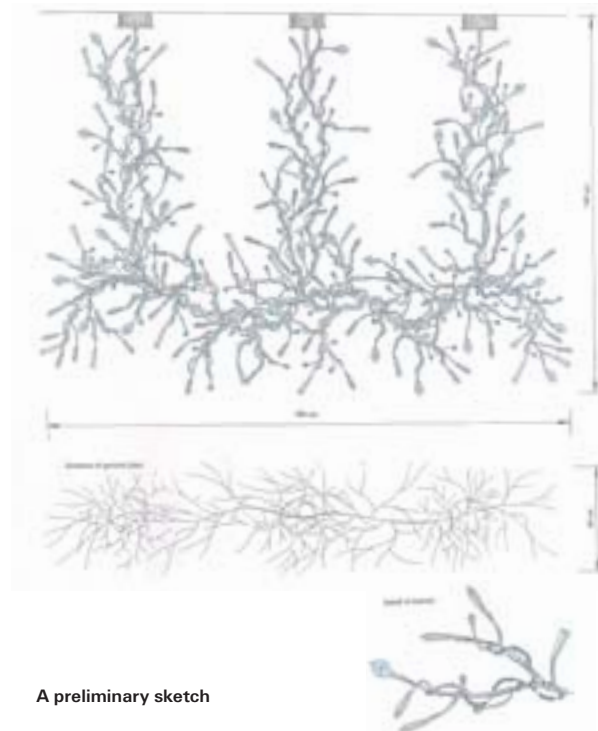

A preliminary sketch

Customers wanted the crystal chandelier to represent a tree branch in spring blossom. Preciosa designed a lighting fixture with both colored and clear crystal components. The frame is hand made and bent into an organic shape. The fixture is illuminated by multiple LED diodes placed behind each of the crystal blossoms.



THE CROWNE PLAZA HOTEL, GURGAON, INDIA



The hotel building

The Crowne Plaza Hotel reflects the culture, mystique and hospitality of India, blended with modern facilities to create the finest business hotel of the country.

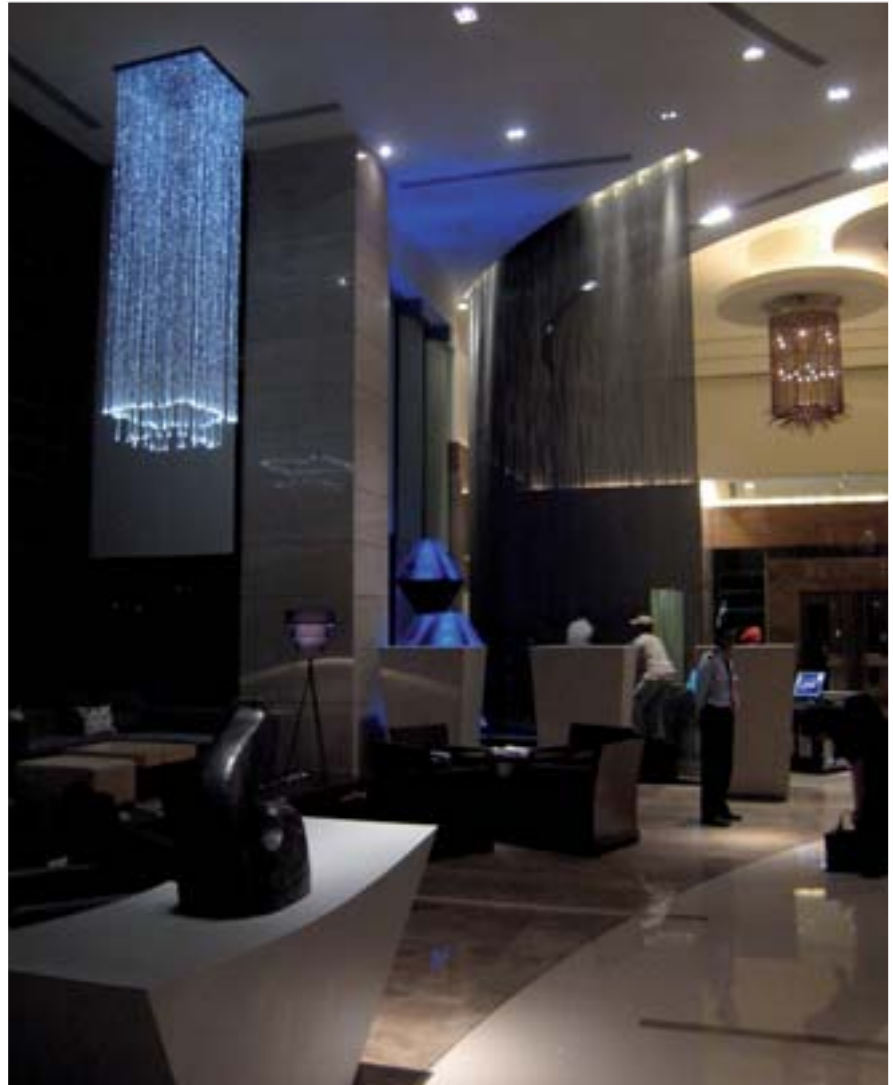

045 480 001 - 02
100 x 100 x 300 cm / 39 x 39 x 118 in

Optical fibers are interwoven and affixed to the fixture's metal frame, with chains formed from cut glass beads of various sizes.

THE CROWNE PLAZA HOTEL, GURGAON, INDIA



A close-up of the fixture

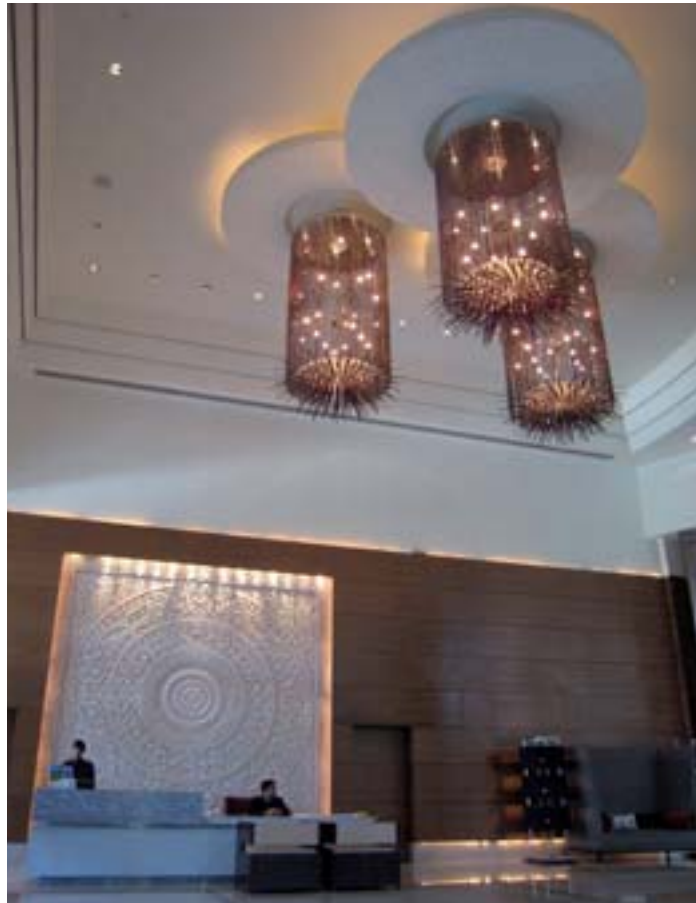

045 723 024 - 06
150 x 270 +100 cm/ 59 x 106 x 39 in

045 723 018 - 07
150 x 220 + 100 cm/ 59 x 42 x 15 in

The fixture's body is formed from chains of trimmings in smoky taupe and matte smoky taupe. The fixture's bottom part is decorated with mouth-blown red and crystal glass beams. The entire fixture is illuminated by 12 spotlights and 12 halogen bulbs.

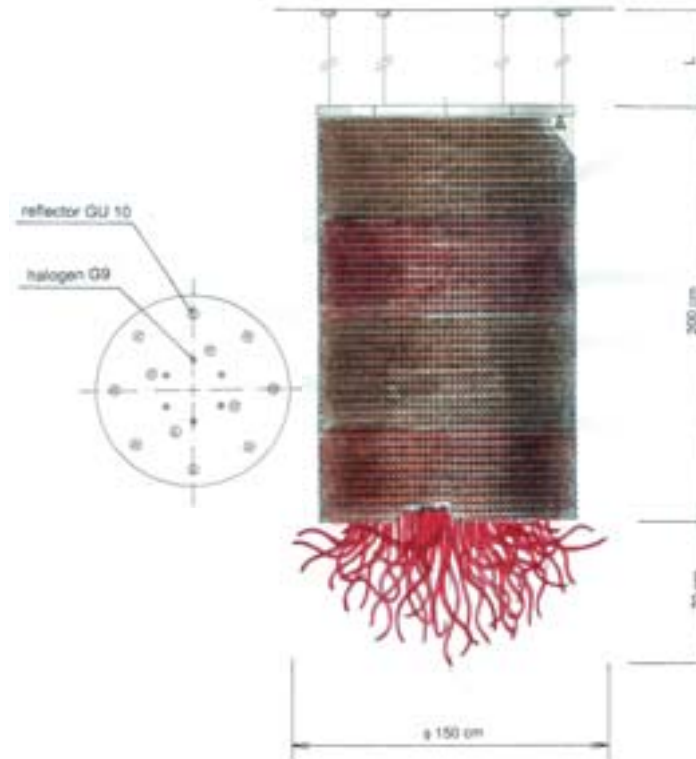

A preliminary project sketch



Inspired by Claude Monet

Design by Jaroslav Bejvl Jr.

The designer of these lighting sculptures was inspired by Claude Monet's impressionist paintings, with 'Water Lilies' from 1906 being his main source of inspiration.



Water lilies

Claude Monet :

„... I buried myself in my work. Those landscapes with their watery reflections have become an obsession with me.”

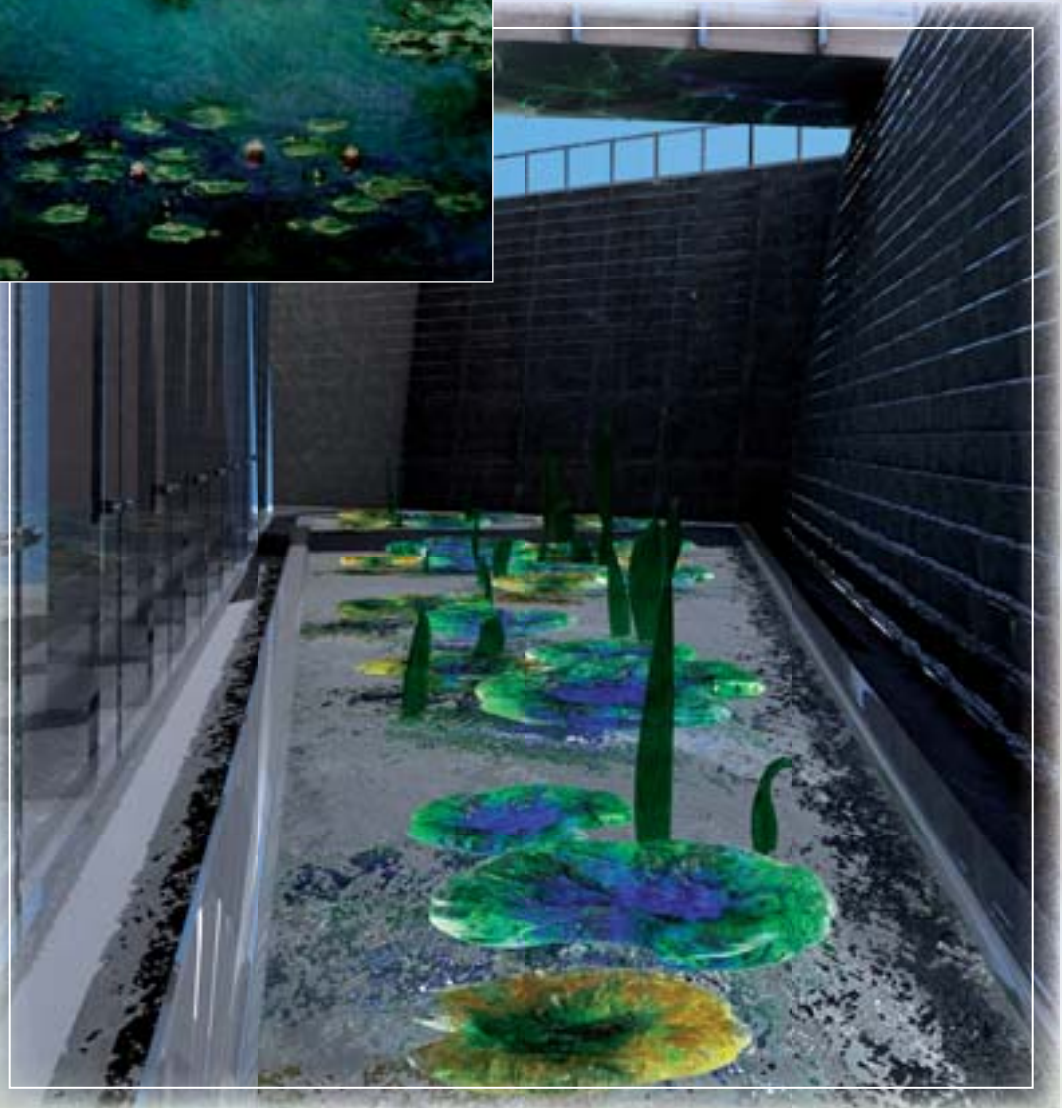

Water lilies

Illuminated from below, glass sculptures – altogether 24 water lilies and 20 leaves 75 - 130 cm in height – are spread all over the surface of the water.



Inspired by Claude Monet

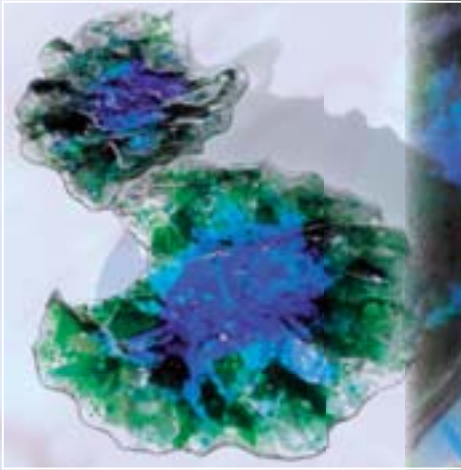

The depicted glass water lilies are made to the designer's original design, using a special glassmaking technique for sintering different layers of glass in various colors. The lilies' surface is finished using a sophisticated nanotechnological technique – a special lacquer is applied to the water lilies' surface, preventing scale from settling and dirt from accumulating on the lilies' surface, which, at the same time, creates a surface tension on all glass components, making water to form bead-like drops of dew on them.

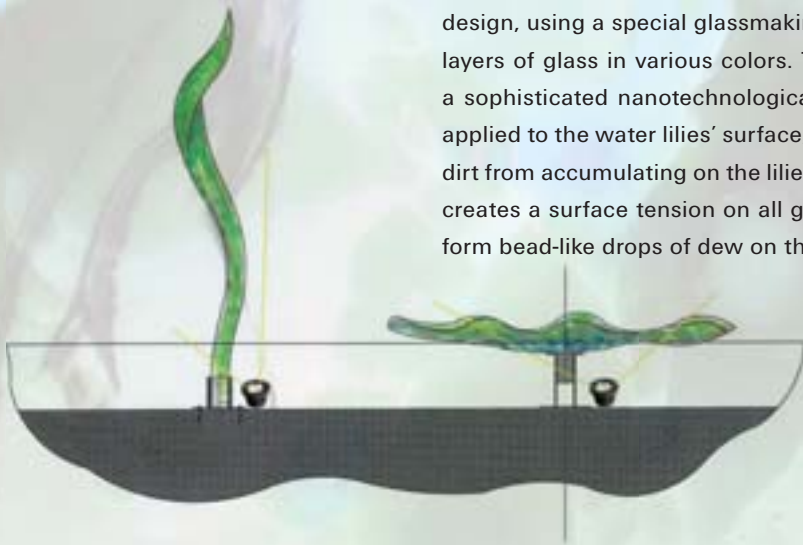

A technical drawing

Inspired by Claude Monet



A technical drawing

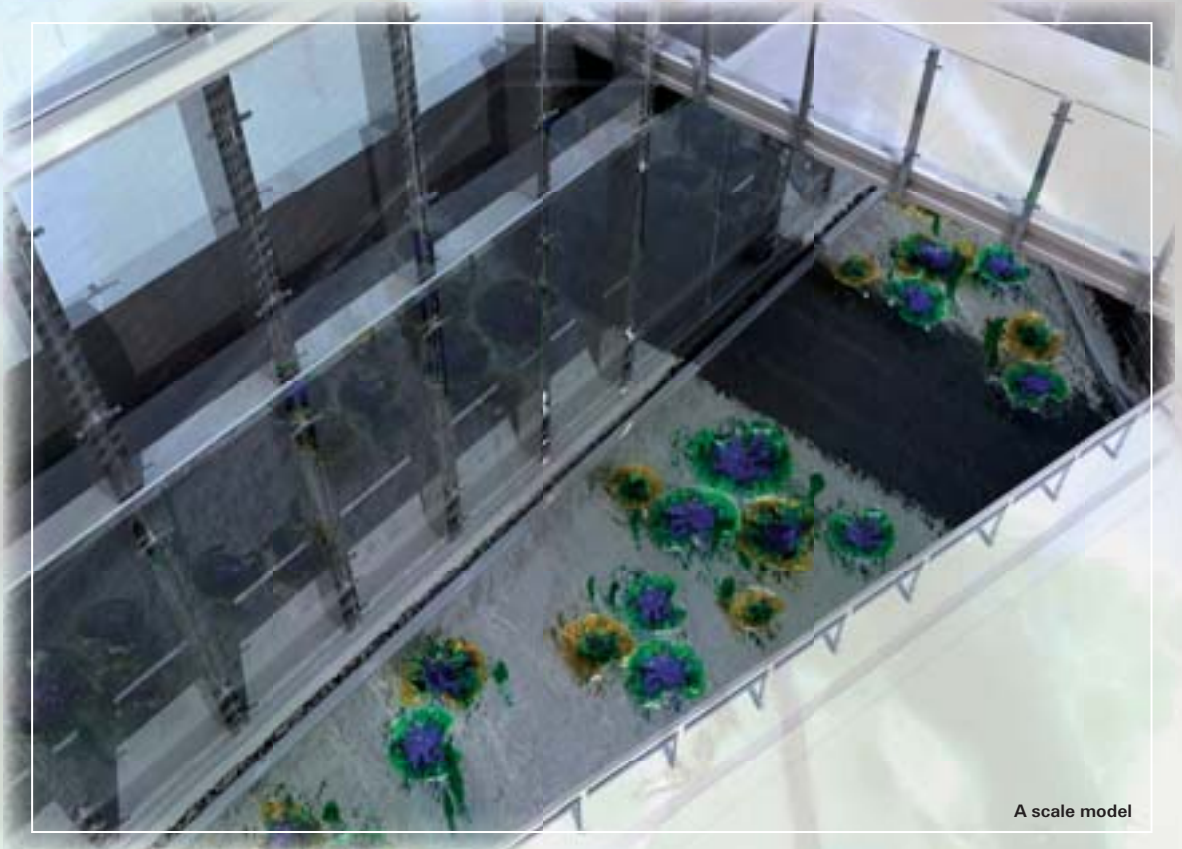

A scale model



PRECIOSA

Inspired by Claude Monet

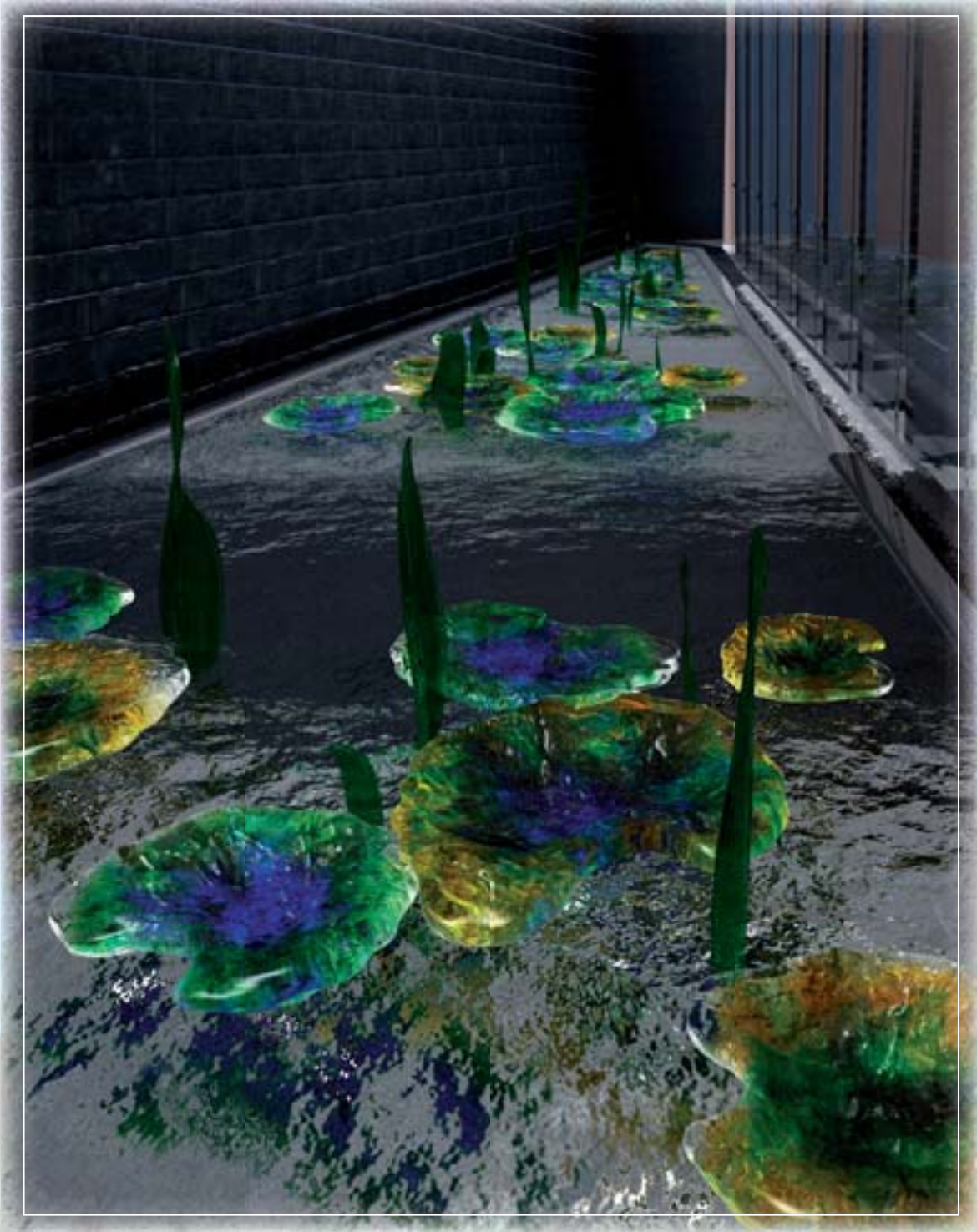

A scale model

New Creative Ideas

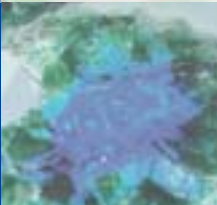

Inspired by mythology and legends

Design by Jaroslav Bejvl and Jaroslav Bejvl Jr.

The architect's task was to design lighting objects in the form of traditional Chinese symbols – Phoenix and Dragon – for the hotel's luxurious restaurant furnished in the typical Chinese style. The symbols are designed to be placed on the restaurant's supporting pillars. Our designers were inspired by these mythical creatures as depicted in Chinese folklore and art.



Inspired by mythology and legends



The first step our designers had to take was to draw a sketch depicting these mythical creatures, including an additional sketch of the interior where the objects will be placed.

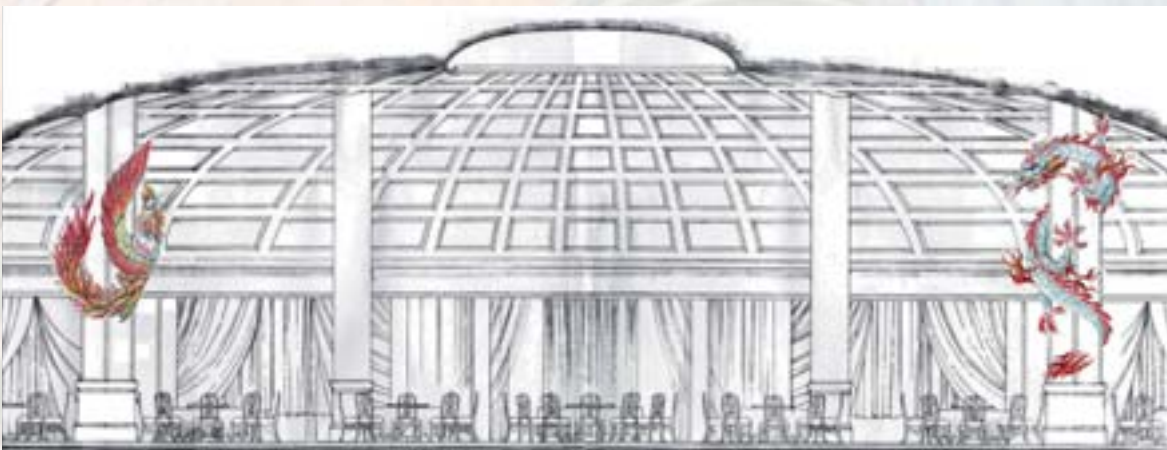

Inspired by mythology and legends

Creating paper scale models of the Phoenix and its glass parts.





PRECIOSA

Inspired by mythology and legends

Creating paper scale models of the Dragon
and its glass parts.

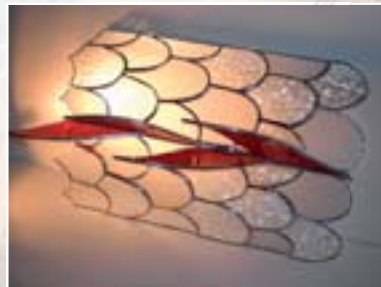

New Creative Ideas



TOP-QUALITY SURFACE FINISHING FOR LIGHTING FIXTURES' METAL COMPONENTS AT PRECIOSA - LUSTRY

Metal component surface finishes are not only a significant feature of lighting fixture design, but also an important functional factor. When stipulating the conditions of an order, it is always important to specify the type of environment in which the fixtures are expected to be installed so that the selected surface finish can sufficiently protect all metal components against mechanical damage and corrosion.

Preciosa - Lustry makes the fixtures' metal components of brass, steel and other stainless metals. These components, available either singly or assembled and manufactured in prescribed shapes and dimensions, are further treated, using special techniques, to achieve the required final surface finish.

It is presumed that most of the ordered lighting fixtures will be installed in buildings with dry and warm atmosphere, not likely to be affected by the rare occurrence of condensation. Therefore, standard surface finishes are quite sufficient for this type of environment.

When installed in a corrosive environment, the lighting fixtures must have a more resistant final surface finish to protect them, which requires thicker layers of electroplated coatings, thicker or more layers of paint, more resistant lacquers, etc.

Final surface finishes fall into three groups, depending on the resulting color shade of the fixtures' metal components:

1. Golden brass finish

means the finishing of a brass component's surface by means of polishing, tarnishing, cutting, dipping or sand-blasting techniques, followed by a thin layer of a colorless or colored transparent, or matte if required, protective baking enamel applied to the treated surface.



TOP-QUALITY SURFACE FINISHING FOR LIGHTING FIXTURES' METAL COMPONENTS AT PRECIOSA - LUSTRY

2. Silver finish

means

a) the finishing of a metal component's surface to achieve a glossy silver look. Thus prepared, the surface is then nickel plated, followed by a decorative chromium layer applied to it;

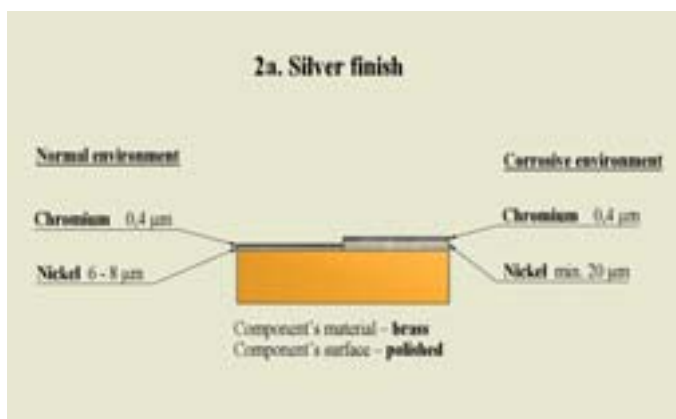

b) the finishing of a component's silver surface to achieve the required effects by means of polishing, tarnishing or cutting and sand-blasting techniques. Thus prepared, the surface is then nickel plated, which is followed by a thin layer of a colorless or colored transparent, or matte if required, protective baking enamel applied to the treated surface.

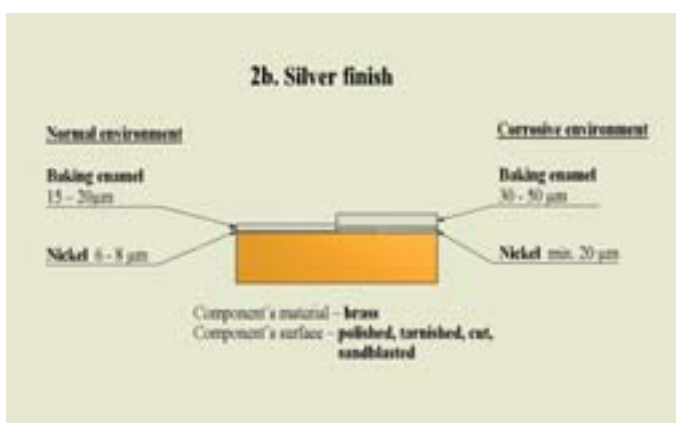

3. Genuine gold finish

means the finishing of a component's polished surface by means of nickel- and gold- plating techniques, followed by a thin layer of a transparent protective baking enamel applied to the treated surface.

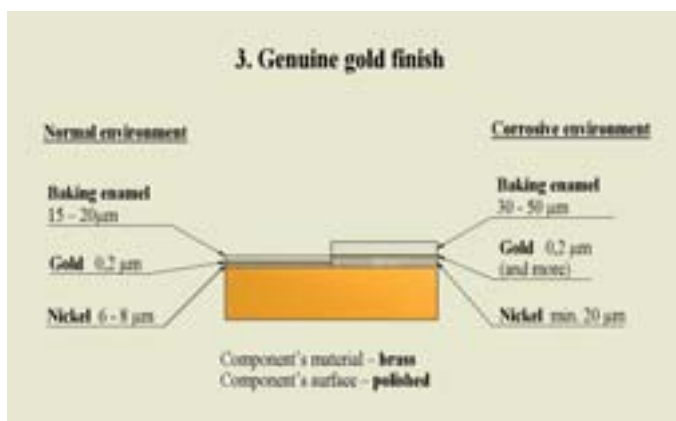

Naturally, our company also respects our customers' special requirements. We are happy to fulfill any special requests after a mutual discussion about the final design and the type of environment in which the fixtures are expected to be installed. Thus, we are prepared to supply an original surface finish that may not be part of our general offerings, e.g. a special color shade of the baking enamel, patina, thicknesses of electroplated layers (nickel, gold) or combinations of these, thicknesses of enamel layers.

COUNTRY:	NAME:	CITY:	YEAR:
Australia	The Wentworth Hotel	Sydney	2003
	The Shagri-La	Sydney	2004
Bahrain	The Al Rowdah Palace - Formal Majlis	West Riffa	2001
	Majlis Palace	Manama	2004
The Czech Republic	Restaurant Bellevue	Prague	2006
	The Mandarin Oriental Hotel	Prague	2006
	The Crowne Plaza Hotel	Prague	2007
Denmark	The Royal Palace	Copenhagen	2002
Germany	Adlon Palais	Berlin	2002
	The Kempinski Hotel	Heiligedamm	2003
	Municipal Hall	Kassel	2004
	Olympic Stadion Berlin	Berlin	2004
Greece	The Astir Palace Hotel	Athens	2004
	The Pentelikon Hotel	Athens	2004
	Regency Casino Mont Parnes	Athens	2006
Hong Kong, S.A.R.	The Ritz-Carlton Hotel	Hong Kong	2003
	The Kowloon Shangri-La Hotel	Hong Kong	2003-5
	The Island Shangri-La Hotel	Hong Kong	2003-5
	The Harlan's restaurant	Hong Kong	2004
	The Cuisine Cuisine restaurant	Hong Kong	2005
	The Four Seasons Hotel	Hong Kong	2005
	The Four Seasons Hotel - French Restaurant	Hong Kong	2005
	The Arch	Hong Kong	2006
Hungary	The Gresham Four Seasons Hotel	Budapest	2004
China P.R.	Portman Plaza Hotel	Ningbo	2005
	The Regent Shanghai Hotel	Shanghai	2005
	The Fortune Centre	Beijing	2005
	The Pudong Shangri-la	Shanghai	2006
	The Regent Hotel	Beijing	2006
	Lan, South Beatuy Restaurant	Beijing	2006
	The Suzhou Center	Suzhou	2007
India	Le Royal Meridien Hotel	Mumbai (Bombay)	2000-5
	The Taj Chandigarh Hotel	Chandigarh	2004
	Milan Loonkar	Mumbai	2006
	Darshan Hiranandani	Mumbai	2006
	The Crowne Plaza Hotel	Gurgaon	2007
Indonesia	The Mulia Hotel & Mulia Café	Jakarta	2007
Italy	Teatro Comunale (Theatre)	Modena	1998
Ireland	The Killashee House Hotel	Naas	2003
	The Cavan Crystal Hotel	Cavan	2003
Japan	The Industry Club	Tokyo	2003
	The Okura Hotel	Sapporo	2003
	The Okura Hotel	Kobe	2003
	The Royal Chester Wedding Palace	Ota	2003
	The Royal Chester Wedding Palace	Fukuoka Miyakonoji	2003
	The Grand Patio Hotel	Tokyo	2003
	The Imperial Hotel	Sapporo	2003
	The Swissotel Nankai Hotel	Osaka	2004
	The Mandarin Oriental Hotel	Tokyo	2005
Kuwait	The Crowne Plaza Hotel - Restaurant Sakura	Kuwait	2007
Malaysia	Istana Mellawati - Royal Palace	Kuala Lumpur	2002
	The Westin Hotel	Kuala Lumpur	2003
	Le Meridien Hotel	Kuala Lumpur	2004
Marocco	Ain Aouda Palace	Rabat	2005

COUNTRY:	NAME:	CITY:	YEAR:
Oman	Barr al Jissah Resort & Spa	Muscat	2006
	State Council Building	Muscat	2006
Philippines	The Shangri-La Mactan	Mactan	2005
	The Shangri-La Manila - EDSA	Manila	2005
Poland	The Basilica	Katowice	2002
	The Westin Hotel	Warsaw	2003
	Hotel Boner Palace	Krakow	2007
Russia	The Bolshoy Theatre – the Small Stage	Moscow	2002
	The Presidential Palace	Moscow	2004
	The Swissotel Moscow Hotel	Moscow	2005
	The Building of State Philharmony	Astrakhan	2007
	The Czaricyno Palace	Moscow	2007
Saudi Arabia	Kingdom Center	Riyadh	2001
	Private Residence	Riyadh	2003
Singapore	The Shangri-La Hotel	Singapore	2003
	The Ritz-Carlton Hotel	Singapore	2004
	Tan Tock Seng Hospital - The Healing Garden	Singapore	2006
	The St.Regis Hotel	Singapore	2006
	Condrad Business Center	Singapore	2006
Spain	The Grand Theatre	Cordoba	2003
South Korea	The Sheraton Walker Hill Hotel	Seoul	2001
	The Paradise Hotel	Busan	2002
	The Radisson Plaza Hotel	Seoul	2002
	The Hotel Lotte	Seoul	2003-5
Switzerland	The Park Hyatt Hotel	Zurich	2004
Thailand	The Mandarin Oriental Hotel	Bangkok	2004
	The Royal Orchid Sheraton Hotel	Bangkok	2004
	Lawadan Palace	Bangkok	2004
U.A.E.	The Emirates Palace Hotel	Abu Dhabi	2004
	The Sheraton Hotel	Dubai	2004
	AL-Mulla Majlis Villa	Dubai	2005
	The Park Hyatt Hotel and Spa	Dubai	2005
	The Kempinski Hotel	Dubai	2006
	The Intercontinental&Crowne Plaza Hotel	Dubai	2007
	The Qamardeen Hotel, The Old town	Dubai	2007
	The Ritz-Carlton Dubai	Dubai	2007
U.S.A.	The Ritz-Carlton Hotel	New Orleans	2000
	The Ritz-Carlton Hotel	Philadelphia	2000
	The Ritz-Carlton Hotel	Washington D.C.	2000
	The Hilton Hotel	Omaha, Nebraska	2004
	Princeton University McCarter Theatre	Princeton	2004
	The Mandarin Oriental Hotel	Washington D.C.	2004
	Richard Nixon Presidential Library	Yorba Linda	2004
	Caesars Palace	Las Vegas	2005
	Wynn Las Vegas Casino	Las Vegas	2005
	Disney` s Beach Club Resort	Orlando	2006
	Red Rock Casino	Las Vegas	2006
	St. Regis Hotel	San Francisco	2006
	Palace Hotel	New York	2007
	The Condrad Hotel	Indianapolis	2007
	The Grand Hyatt Hotel	San Antonio	2007
	The Trump Hotel&Casino	Las Vegas	2007
	The Trump Tower	Chicago	2007
	The Golden Nugget Hotel&Casino	Las Vegas	2007
	The Gaylord Hotel	Baltimore	2008

PRECIOSA CUSTOMER CENTRE

Opletalova 3197
466 67 Jablonec nad Nisou
Czech Republic
Tel.: +420 488 115 555
Fax: +420 488 115 665
E-mail: info@preciosa.com
www.preciosa.com

PRECIOSA WORLDWIDE :

PRECIOSA INTERNATIONAL (HK) LTD.
Lighting Division
Unit 2016, Chevalier Commercial Centre
8 Wang Hoi Road, Kowloon Bay, Kowloon
Hong Kong
S.A.R.
Tel.: +852 2753 9595
Fax: +852 2753 9997
E-mail: info@preciosa.com.hk

PRECIOSA (SG) PTE. LTD.
51 Goldhill Plaza #08-08/09
Singapore 308900
Tel.: +65 6256 2212
Fax: +65 6256 1101
E-mail: sales@sg.preciosa.com

PRECIOSA INTERNATIONAL, INC.
2316 Wehrle Drive
Williamsville, NY 14221
U.S.A.
Tel.: + 1 716 626 9759
Fax: + 1 716 626 9758
E-mail: sales@ny.preciosa.com

PRECIOSA GULF, FZCO
P.O.Box 18185
Dubai
United Arab Emirates
Tel.: + 971 48 838 473
Fax: + 971 48 837 913
E-mail: sales@gulf.preciosa.com

PRECIOSA INTERNATIONAL SK, s.r.o.
Kalvínske námestie 2,
934 01 Levice
Slovak Republic
Tel.: + 421 366 224 124
Fax: + 421 366 224 124
E-mail: sales@sk.preciosa.com

PRECIOSA CENTR, A. O.
Office 150, Entr. 7
4th Tverskaya - Yamskaya Str., 33/39
125010 Moscow
Russia
Tel./Fax: +7 495 961 31 07
+7 495 961 31 08
E-mail: infocentr@preciosa.ru

PRECIOSA Leuchten GmbH
Hauptstr. 37
D-95676 Wiesau
Germany
Tel.: + 49 - 96 - 34 91 59 430
Fax: + 49 - 96 - 34 91 59 460
E-mail: sales@leuchten.preciosa.com



